

SCHOCK

SCHOCK

SCHOCK



GROBPARTIKELFILTER **SF-100**

629883
629883/1 

Als zusätzlicher Schutz
für Kartusche und Perlator

For added protection
for the cartridge and aerator.



www.schock.de/shop



www.schock.de/sf100

629883 + 629883/1

SCHOCK GmbH
Hofbauerstr. 1 • D-94209 Regen
Telefon: +49-9921-600-0

Email: info@schock.de • www.schock.de

61157



INSTALLATION INSTALLATION

1

Einbau am Eckventil und Anschluss an der Armatur

Fit filter to angle valve and connect to tap

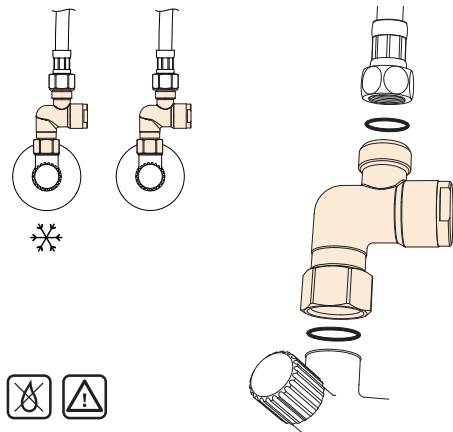

REINIGUNG CLEANING

1

Öffnen des Schmutzsiebes

Unscrew strainer

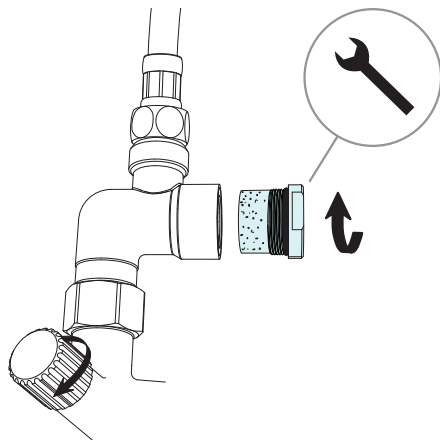

2

Geöffneten Partikelfilter spülen Schmutzsieb reinigen

Flush opened particle filter and clean strainer

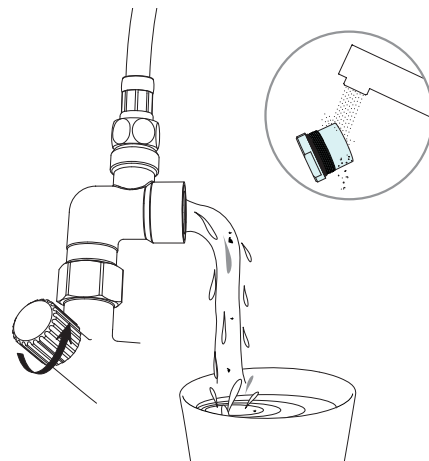

3

Schmutzsieb wieder zusammenbauen

Screw strainer back into place

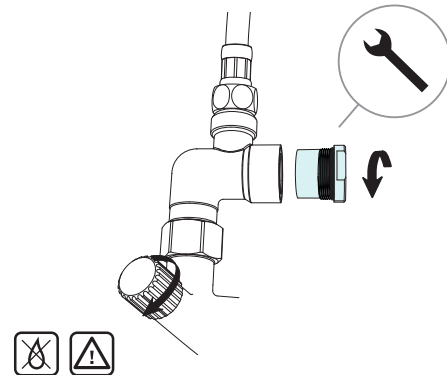

Empfohlenes Reinigungsintervall: 12 Monate

Cleaning recommended every 12 months